

visocolor® ECO Chlor 1 (frei) Chlorine (free)/Chlore (libre)/Cloro (libre)

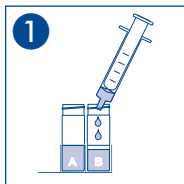

Messbereich / Range / Domaine de mesure / Rango
0.1–2.0 mg/L Cl₂

REF 931 035
931 235



1
2 x 5 mL Probe
Sample
Echantillon
Muestra



2
1  Cl₂-1

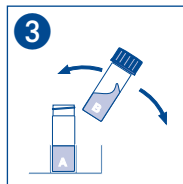

3
20 s Schütteln
Shake
Agiter
Agitar

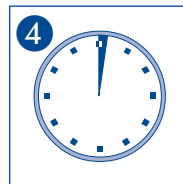

4
1'00 min

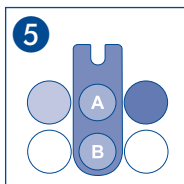

5
Messung
Measurement
Mesure
Medición



Meerwasser
Sea water
Eau de mer
Agua de mar

visocolor® ECO Chlor 1 (gesamt) Chlorine (total)/Chlore (totale)/Cloro (total)

Messbereich / Range / Domaine de mesure / Rango
0.1–2.0 mg/L Cl₂

REF 931 035
931 235

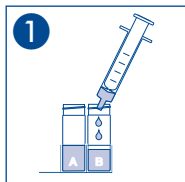

1
2 x 5 mL Probe
Sample
Echantillon
Muestra

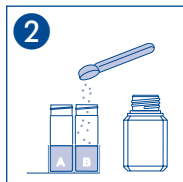

2
1  Cl₂-1

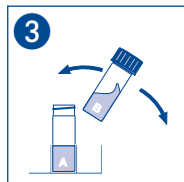

3
20 s Schütteln
Shake
Agiter
Agitar

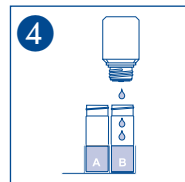

4
3  Cl₂-2

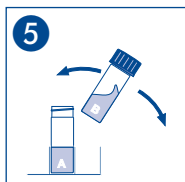

5
Schütteln
Shake
Agiter
Agitar

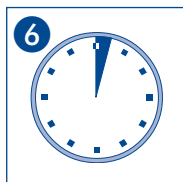

6
2'00 min

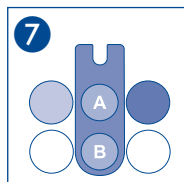

7
Messung
Measurement
Mesure
Medición



Meerwasser
Sea water
Eau de mer
Agua de mar