

visocolor[®] ECO Kieselsäure

Silica / Silice

Test 5-33

REF 931 233

690 nm

Method(e) / Método

5331

0.2–3.0 mg/L SiO₂

5332

0.1–1.4 mg/L Si

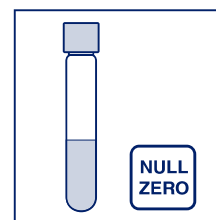

Probe / sample
échantillon / muestra



1
Küvetten spülen
Rinse test tubes
Rincer les éprouvettes
Lavar los tubos

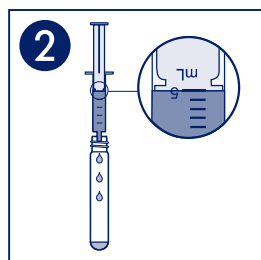

2
5 mL Probe
Sample
Echantillon
Muestra

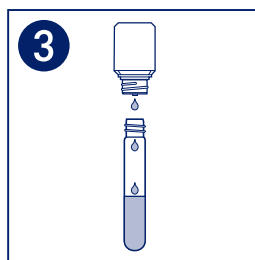

3
5 SiO_2 -1

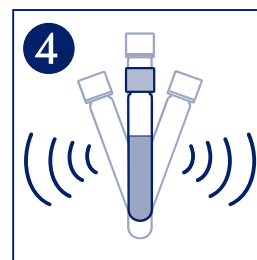

4
Schütteln
Shake
Agiter
Agitar

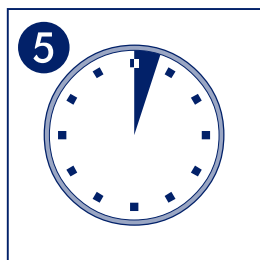

5
3'00 min

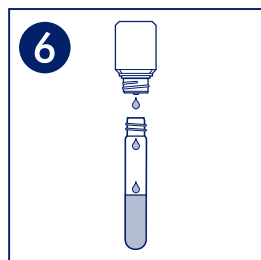

6
5 SiO_2 -2



7
Schütteln
Shake
Agiter
Agitar

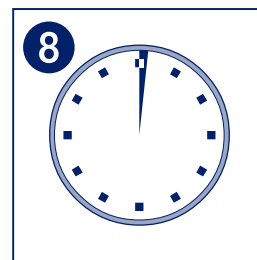

8
1'00 min

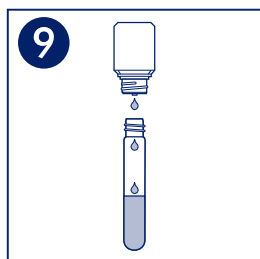

9
5 SiO_2 -3



10
Schütteln
Shake
Agiter
Agitar

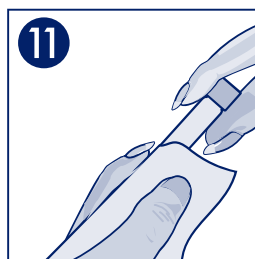

11
Säubern
Clean
Nettoyer
Limpiar

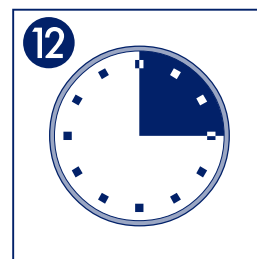

12
15'00 min



13
Messung
Measurement
Mesure
Medición

Meerwasser
Sea water
Eau de mer
Agua de mar

