



Method(e):

0991

40–600 mg/L C

20–80 %:

40 152

488 600 mg/L C



REF 985 099

1/2

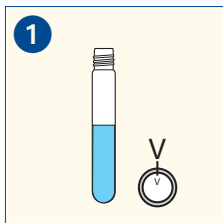

Küvette / Tube
Cuve / Tubo

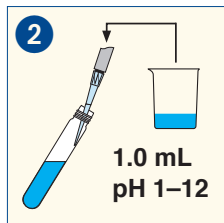

Probe / Sample
Échant. / Muestra

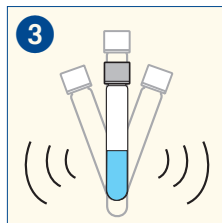

Schütteln / Shake
Agitar / Agitar

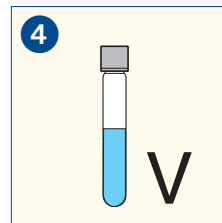

Lösung / Solution
Solución

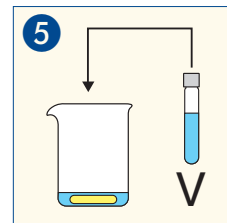

Umfüllen / Decant
Dépoter / Trasegar

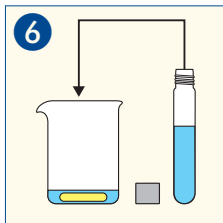

500 µL R0

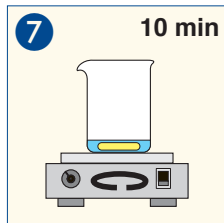

Rühren / Stirr
Agiter / Agitar

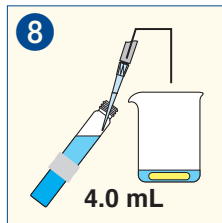

in Küvette / into tube
dans cuve / en tubo

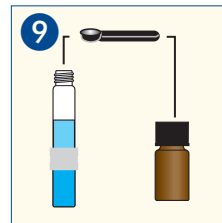

1  R2

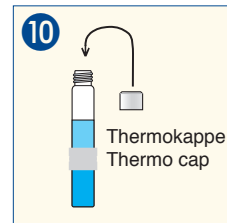

Schließen / Close
Fermer / Cerrar



Method(e):

0991

40–600 mg/L C

20–80 %:

40

152

488

600 mg/L C



REF 985 099

2/2

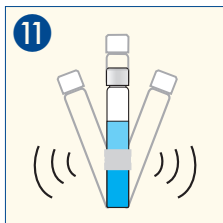

Schütteln / Shake
Agiter / Agitar

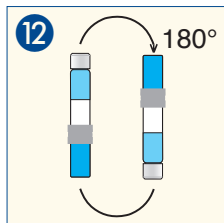

Drehen / Turn
Retourner / Girar

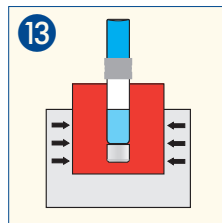

120 °C / 2 h

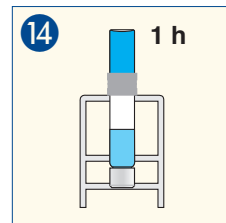

Abkühlen / Cool
Refrroidir / Enfriar

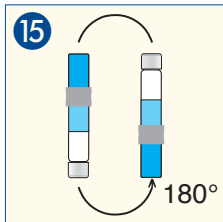

Drehen / Turn
Retourner / Girar

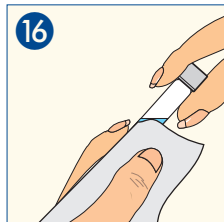

Säubern / Clean
Nettoyer / Limpiar



Messen / Measure
Mesurer / Medir